

## **4K (8MP), TDN, WDR, IR, INTELLIGENT BULLET**



### *Fixed Lens Bullet*

## **IPB4K28AIX**

- > Fully Adheres to National Defense Authorization Act (NDAA) Guidelines
- > Exceptional Video Quality with 4K (8MP), 3840 x 2160 Resolution
- > Super-Efficient H.265 Video Compression for Drastically Reduced Bandwidth and Storage Requirements
- > Powerful, Smart IR LED Lights for 0Lux Night Time Operation up to 98 Feet
- > 2.8mm fixed lens; Triple Video Streams; ONVIF Profile S Compliant
- > TRUE Day/Night and WDR functionality for all Lighting Conditions
- > Backlight Compensation, Corridor Mode, Defog and 3D DNR (Digital Noise Reduction)
- > Two-way Audio w/ Built-In Speaker / Microphone; Built-in Micro-SD Card Slot enables local storage up to 256GB
- > Intelligent perimeter protection such as cross line and intrusion, with smart intrusion prevention technology for significantly reduced false alarms when focusing on humans and motor vehicles
- > Supports Sound & Light Alarm Alerts when Smart Intrusion is Detected
- > PoE & 12VDC Power Options, IP67 Weather Resistant Housing, Optional Mounts Available
- > Supported by uniview tec Guard Station Software and Guard Viewer Mobile App's for iPhone and Android Devices

[www.univiewtechnology.com](http://www.univiewtechnology.com)



UVT7991022-01

## Specifications

Camera	
Sensor	1/2.7", progressive scan , 8 megapixel, CMOS
Lens	2.8mm @ F2.0
Angle of View (H x V)	112.4° x 60.1°
Shutter	Auto/Manual, 1 ~ 1/100000 s
Minimum Illumination	Color: 0.01 Lux (F2.0, AGC ON); 0 Lux with IR
Day/Night	IR-cut filter with auto switch (ICR)
Digital noise reduction	2D/3D DNR
IR LED Range	Up to 30m (98 ft) IR range
WDR	120dB
Video Compression	Ultra 265, H.265, H.264, MJPEG
H.264 code profile	Baseline profile, Main Profile, High Profile
Maximum Frame Rate / Stream	Main: 8MP (3840 x 2160) @ 20 fps Sub: 1080P (1920 x 1080): @ 30 fps Third Stream: D1 (720 x 576) @ 30fps
HLC, BLC, 9:16 Corridor, Defog, Flip, De-Warping, Alarm Light	Supported
OSD, Privacy Mask, Motion Detection & ROI	Up to 8 areas
Network	
Protocols	IPv4, IGMP, ICMP, ARP, TCP, UDP, DHCP, PPPoE, RTP, RTSP, RTCP, DNS, DDNS, NTP, FTP, UPnP, HTTP, HTTPS, SMTP, 802.1x, SNMP, QoS ,RTMP, SSL/TLS, SSH
Compatible Integration	ONVIF (Profile S, G, T), API
Local & Network Storage	Micro-SD, up to 256GB; ANR
Network	RJ45, 10M/100M Base-TX Ethernet
Intelligent Perimeter Protection	Line Crossing, Intrusion & Leave Area detection w/ Smart Intrusion Prevention Technology for False Alarm Prevention
General	
Power	12VDC +/- 25%, PoE (IEEE802.3 af); Max 10.5W
Dimensions (L x W x H) & Weight	191 x 75 x 74mm (7.5 x 3 x 2.9"); 0.41kg (0.9lb)
Audio & Compression	Built-in Mic & Speaker; G.711
Adjustment Range	Pan: 0°~360° Tilt: 0° ~ 90° Rotation: 0°~360°
Operating Temperature & Humidity	-30°C ~ +60°C (-22°F ~ 140°F); Humidity: 10%~95% RH (non-condensing)
Conformity Certifications	IP67, CE, FCC

## Dimensions

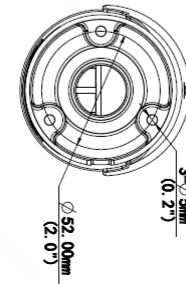
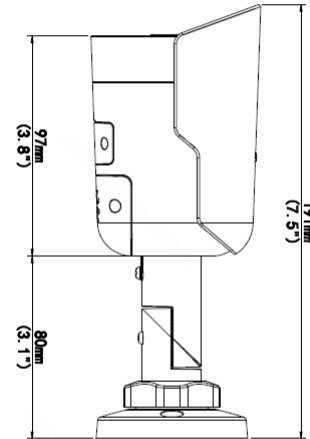
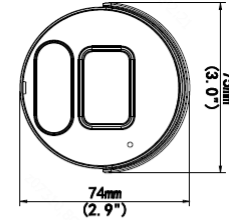

## Accessories

See Camera Accessories Guide